



NATIONAL ASSOCIATION OF POSTAL SUPERVISORS

National Headquarters
1727 KING STREET, SUITE 400
ALEXANDRIA, VA 22314-2753
(703) 836-9660

March 23, 2026

Board Memo 015-2026: Latest RPDC Presentation

Executive Board,

NAPS HQ has received from the USPS the latest update on RPDC sites under construction in accordance with the DFA plan.

Thank you and be safe.

NAPS Headquarters

Network Updates

03/26/2026

18 RPDC regions under modernization

RPDC regions under modernization

- 1 **Atlanta, GA** – Significantly active
- 2 **Portland, OR** – Significantly active
- 3 **Richmond, VA** – Significantly active
- 4 **Boise, ID** – Significantly active
- 5 **Houston, TX** – Significantly active
- 6 **Chicago, IL** – Significantly active
- 7 **Charlotte, NC** – Significantly active
- 8 **Indianapolis, IN** – Significantly active
- 9 **Jacksonville, FL** – Significantly active
- 10 **Phoenix, AZ** – Regional Transfer Hub active
- 11 **Denver, CO** – Regional Transfer Hub active
- 12 **Dallas, TX** – Regional Transfer Hub active
- 13 **Kansas City, MO** – Regional Transfer Hub active
- 14 **Memphis, TN** – Regional Transfer Hub active
- 15 **Jersey City, NJ** – Partially active
- 16 **Birmingham, AL** – Partially active
- 17 **Greensboro, NC** – Partially active
- 18 **St. Louis, MO** – Partially active

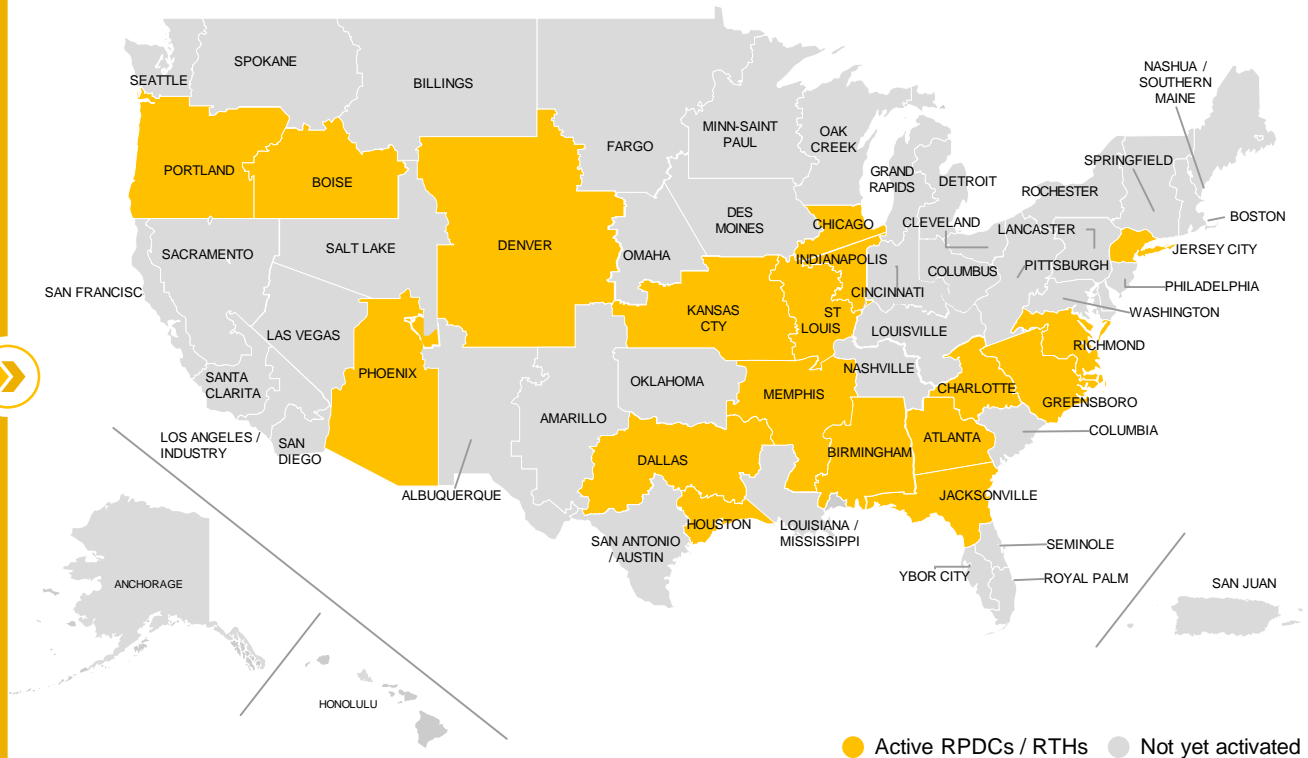

This presentation reflects the current strategic thinking of the Postal Service that is part of an ongoing deliberative process, that is not final, and that is subject to adjustment and/or change. The presentation also contains commercially sensitive business proprietary information that should not be further disclosed without the express written permission of the Postal Service.

RPDC activation status definitions

Status	Definition
Initial state	They have not yet updated their mail and package flow to future-state and are in design or initial fit-out phase.
Partially active	They have adopted a new layout, but are not processing all future-state products and/or ZIP Codes. The main package sorter(s) are running at partial capacity.
Significantly active	They are processing majority of future-state products and/or ZIP Codes with the main package sorter(s) at full operations.
Regional Transfer Hub active	They are processing network volume, enabling origins to reduce the number of separations and send mail and packages to a single consolidation point versus many destinating plants. The RTH then sorts and distributes to destinating plants in their region.

PILS Phase	Machine #	SITE NAME	PILS / PILS-Lite	OSL Need By Date	Site Survey	Installation	Training / Burn-In	Acceptance Testing	Accepted by Date	Start of Operations / Support
One	16	YBOR CITY FL P&DC (PILS-2)	PILS	1/1/2026	1/29/2026	3/5/2026	3/12/2026	4/2/2026	4/7/2026	4/9/2026
One	17	Memphis RPDC (PILS-3)	PILS	1/8/2026	2/10/2026	3/12/2026	3/19/2026	4/9/2026	4/14/2026	4/16/2026
One	18	Sacramento CA P&DC (PILS-1)	PILS	1/15/2026	2/5/2026	3/19/2026	3/26/2026	4/16/2026	4/21/2026	4/23/2026
Two	1 (19)	MEMPHIS RPDC (PILS-4)	PILS	1/22/2026	11/21/2025	3/26/2026	4/2/2026	4/23/2026	4/28/2026	4/30/2026
Two	3 (21)	Des Moines IA NDC (PILS-1)	PILS	1/29/2026	2/9/2026	4/2/2026	4/9/2026	4/30/2026	5/5/2026	5/7/2026
Two	4 (22)	SALT LAKE CITY UT ASF (PILS-1)	PILS	1/29/2026	2/11/2026	4/2/2026	4/9/2026	4/30/2026	5/5/2026	5/7/2026
Two	5 (23)	West Valley AZ P&DC (PILS-1)	PILS	2/5/2026	2/9/2026	4/9/2026	4/16/2026	5/7/2026	5/12/2026	5/14/2026
Two	6 (24)	RICHMOND VA RPDC (PILS-1)	PILS	2/5/2026	1/29/2026	4/9/2026	4/16/2026	5/7/2026	5/12/2026	5/14/2026
Two	7 (25)	KANSAS CITY MO P&DC (PILS-1)	PILS	2/12/2026	3/19/2026	4/16/2026	4/23/2026	5/14/2026	5/19/2026	5/21/2026
Two	8 (26)	LOUISVILLE KY P&DC (PILS-1)	PILS	2/12/2026	3/19/2026	4/16/2026	4/23/2026	5/14/2026	5/19/2026	5/21/2026
Two	9 (27)	COLUMBIA SC P&DC (PILS-1)	PILS	2/19/2026	12/1/2025	4/23/2026	4/30/2026	5/21/2026	5/26/2026	5/28/2026
Two	10 (28)	INDUSTRY CA P&DC (PILS-2)	PILS	2/19/2026	3/26/2026	4/23/2026	4/30/2026	5/21/2026	5/26/2026	5/28/2026
Two	11 (29)	Manasota FL P&DC (PILS-1)	PILS	2/26/2026	1/29/2026	4/30/2026	5/7/2026	5/28/2026	6/2/2026	6/4/2026
Two	12 (30)	Oak Creek WI P&DC (PILS-1)	PILS	2/26/2026	4/2/2026	4/30/2026	5/7/2026	5/28/2026	6/2/2026	6/4/2026
Two	13 (31)	LAS VEGAS NV P&DC (PILS-1)	PILS	3/5/2026	4/9/2026	5/7/2026	5/14/2026	6/4/2026	6/9/2026	6/11/2026
Two	14 (32)	Royal Palm FL P&DC (PILS-1)	PILS	3/5/2026	4/9/2026	5/7/2026	5/14/2026	6/4/2026	6/9/2026	6/11/2026
Two	15 (33)	Los Angeles CA P&DC (PILS-1)	PILS	3/12/2026	4/16/2026	5/14/2026	5/21/2026	6/11/2026	6/16/2026	6/18/2026
Two	16 (34)	COLUMBUS OH P&DC (PILS-2)	PILS	3/12/2026	4/16/2026	5/14/2026	5/21/2026	6/11/2026	6/16/2026	6/18/2026
Two	17 (35)	Sacramento CA P&DC (PILS-2)	PILS	3/19/2026	4/23/2026	5/21/2026	5/28/2026	6/18/2026	6/23/2026	6/25/2026
Two	18 (36)	Sioux Falls SD P&DC (PILS-1)	PILS	3/19/2026	2/11/2026	5/21/2026	5/28/2026	6/18/2026	6/23/2026	6/25/2026
Two	19 (37)	Birmingham RPDC (PILS-2)	PILS	4/2/2026	2/2/2026	6/4/2026	6/11/2026	7/2/2026	7/7/2026	7/9/2026
Two	20 (38)	Birmingham RPDC (PILS-3)	PILS	4/2/2026	2/2/2026	6/4/2026	6/11/2026	7/2/2026	7/7/2026	7/9/2026
Two	21 (39)	Denver RPDC (PILS-1)	PILS	4/9/2026	5/14/2026	6/11/2026	6/18/2026	7/9/2026	7/14/2026	7/16/2026
Three	1 (40)	Denver RPDC (PILS-2)	PILS	4/9/2026	5/14/2026	6/11/2026	6/18/2026	7/9/2026	7/14/2026	7/16/2026
Three	2 (41)	KANSAS CITY MO P&DC (PILS-2)	PILS	4/16/2026	5/21/2026	6/18/2026	6/25/2026	7/16/2026	7/21/2026	7/23/2026

PILS Phase	Machine #	SITE NAME	PILS / PILS-Lite	OSL Need By Date	Site Survey	Installation	Training / Burn-In	Acceptance Testing	Accepted by Date	Start of Operations / Support
Three	3 (42)	LOUISVILLE KY P&DC (PILS-2)	PILS	4/16/2026	5/21/2026	6/18/2026	6/25/2026	7/16/2026	7/21/2026	7/23/2026
Three	4 (43)	San Antonio TX Selma PSA (PILS-1)	PILS	4/23/2026	5/28/2026	6/25/2026	7/2/2026	7/23/2026	7/28/2026	7/30/2026
Three	5 (44)	San Antonio TX Selma PSA (PILS-2)	PILS	4/23/2026	5/28/2026	6/25/2026	7/2/2026	7/23/2026	7/28/2026	7/30/2026
Three	6 (45)	Royal Palm FL P&DC (PILS-2)	PILS	4/23/2026	5/28/2026	6/25/2026	7/2/2026	7/23/2026	7/28/2026	7/30/2026
Three	7 (46)	Indianapolis RPDC (PILS - 1)	PILS	5/7/2026	6/11/2026	7/9/2026	7/16/2026	8/6/2026	8/11/2026	8/13/2026
Three	8 (47)	Indianapolis RPDC (PILS - 2)	PILS	5/7/2026	6/11/2026	7/9/2026	7/16/2026	8/6/2026	8/11/2026	8/13/2026
Three	9 (48)	Shreveport LA P&DC (PILS-1)	PILS	5/7/2026	6/11/2026	7/9/2026	7/16/2026	8/6/2026	8/11/2026	8/13/2026
Three	10 (49)	Los Angeles CA P&DC (PILS-2)	PILS	5/14/2026	6/18/2026	7/16/2026	7/23/2026	8/13/2026	8/18/2026	8/20/2026
Three	11 (50)	Cleveland OH P&DC (PILS-1)	PILS	5/14/2026	6/18/2026	7/16/2026	7/23/2026	8/13/2026	8/18/2026	8/20/2026
Three	12 (51)	Lancaster PA P&DC (PILS-1)	PILS	5/14/2026	6/18/2026	7/16/2026	7/23/2026	8/13/2026	8/18/2026	8/20/2026
Three	13 (52)	Queens P&DC (PILS-1)	PILS	5/21/2026	6/25/2026	7/23/2026	7/30/2026	8/20/2026	8/25/2026	8/27/2026
Three	14 (53)	SALT LAKE CITY UT ASF (PILS-2)	PILS	5/21/2026	6/25/2026	7/23/2026	7/30/2026	8/20/2026	8/25/2026	8/27/2026
Three	15 (54)	Omaha NE P&DC (PILS-1)	PILS	5/21/2026	6/25/2026	7/23/2026	7/30/2026	8/20/2026	8/25/2026	8/27/2026
Three	16 (55)	Santa Clarita CA P&DC (PILS-1)	PILS	5/28/2026	7/2/2026	7/30/2026	8/6/2026	8/27/2026	9/1/2026	9/3/2026
Three	17 (56)	Denver RPDC (PILS-3)	PILS	5/28/2026	7/2/2026	7/30/2026	8/6/2026	8/27/2026	9/1/2026	9/3/2026
Three	18 (57)	Fort Myers FL P&DC (PILS LITE-1)	PILS Lite	5/28/2026	7/2/2026	7/30/2026	8/6/2026	8/27/2026	9/1/2026	9/3/2026
Three	19 (58)	Denver RPDC (PILS-4)	PILS	6/4/2026	7/9/2026	8/6/2026	8/13/2026	9/3/2026	9/8/2026	9/10/2026
Three	20 (59)	Denver RPDC (PILS-5)	PILS	6/4/2026	7/9/2026	8/6/2026	8/13/2026	9/3/2026	9/8/2026	9/10/2026
Three	21 (60)	San Antonio TX P&DC (PILS-1)	PILS	6/4/2026	7/9/2026	8/6/2026	8/13/2026	9/3/2026	9/8/2026	9/10/2026
Three	22 (61)	San Antonio TX P&DC (PILS-2)	PILS	6/11/2026	7/16/2026	8/13/2026	8/20/2026	9/10/2026	9/15/2026	9/17/2026
Three	23 (62)	Madison WI P&DC (PILS-1)	PILS	6/11/2026	7/16/2026	8/13/2026	8/20/2026	9/10/2026	9/15/2026	9/17/2026
Three	24 (63)	Champaign IL P&DC (PILS-1)	PILS	6/11/2026	7/16/2026	8/13/2026	8/20/2026	9/10/2026	9/15/2026	9/17/2026
Three	25 (64)	St Paul P&DC (PILS-1)	PILS	6/18/2026	7/23/2026	8/20/2026	8/27/2026	9/17/2026	9/22/2026	9/24/2026
Three	26 (65)	INDUSTRY CA P&DC (PILS-3)	PILS	6/18/2026	7/23/2026	8/20/2026	8/27/2026	9/17/2026	9/22/2026	9/24/2026

PILS Phase	Machine #	SITE NAME	PILS / PILS-Lite	OSL Need By Date	Site Survey	Installation	Training / Burn-In	Acceptance Testing	Accepted by Date	Start of Operations / Support
Three	27 (66)	Royal Palm FL P&DC (PILS-3)	PILS	6/18/2026	7/23/2026	8/20/2026	8/27/2026	9/17/2026	9/22/2026	9/24/2026
Three	28 (67)	West Palm Beach FL P&DC (PL 1)	PILS Lite	7/2/2026	8/6/2026	9/3/2026	9/10/2026	10/1/2026	10/6/2026	10/8/2026
Three	29 (68)	New Orleans LA P&DC (PILS-1)	PILS	7/2/2026	8/6/2026	9/3/2026	9/10/2026	10/1/2026	10/6/2026	10/8/2026
Three	30 (69)	Cleveland OH P&DC (PILS-2)	PILS	7/2/2026	8/6/2026	9/3/2026	9/10/2026	10/1/2026	10/6/2026	10/8/2026
Three	31 (70)	Des Moines IA P&DC (PILS-1)	PILS	7/9/2026	8/13/2026	9/10/2026	9/17/2026	10/8/2026	10/13/2026	10/15/2026
Three	32 (71)	North Houston RPDC (PILS-1)	PILS	7/9/2026	8/13/2026	9/10/2026	9/17/2026	10/8/2026	10/13/2026	10/15/2026
Three	33 (72)	Fargo ND P&DC	PILS Lite	7/9/2026	8/13/2026	9/10/2026	9/17/2026	10/8/2026	10/13/2026	10/15/2026
Three	34 (73)	Lancaster PA P&DC (PILS-2)	PILS	7/16/2026	8/20/2026	9/17/2026	9/24/2026	10/15/2026	10/20/2026	10/22/2026
Three	35 (74)	Montgomery AL P&DC	PILS Lite	7/16/2026	8/20/2026	9/17/2026	9/24/2026	10/15/2026	10/20/2026	10/22/2026
Three	36 (75)	SAN FRANCISCO CA NDC	PILS Lite	7/16/2026	8/20/2026	9/17/2026	9/24/2026	10/15/2026	10/20/2026	10/22/2026
Three	37 (76)	Los Angeles CA P&DC (PILS-3)	PILS	7/23/2026	8/27/2026	9/24/2026	10/1/2026	10/22/2026	10/27/2026	10/29/2026
Three	38 (77)	Billings MT P&DC	PILS Lite	7/23/2026	8/27/2026	9/24/2026	10/1/2026	10/22/2026	10/27/2026	10/29/2026
Three	39 (78)	Manchester NH	PILS Lite	7/23/2026	8/27/2026	9/24/2026	10/1/2026	10/22/2026	10/27/2026	10/29/2026
Three	40 (79)	Mid Missouri MO P&DF	PILS Lite	7/30/2026	9/3/2026	10/1/2026	10/8/2026	10/29/2026	11/3/2026	11/5/2026
Three	41 (80)	Spokane WA P&DC	PILS Lite	7/30/2026	9/3/2026	10/1/2026	10/8/2026	10/29/2026	11/3/2026	11/5/2026
Three	42 (81)	KNOXVILLE TN P&DC	PILS Lite	7/30/2026	9/3/2026	10/1/2026	10/8/2026	10/29/2026	11/3/2026	11/5/2026
Three	43 (82)	Tulsa OK P&DC	PILS Lite	8/6/2026	9/10/2026	10/8/2026	10/15/2026	11/5/2026	11/10/2026	11/12/2026
Three	44 (83)	St Paul P&DC (PILS-2)	PILS	8/6/2026	9/10/2026	10/8/2026	10/15/2026	11/5/2026	11/10/2026	11/12/2026
Three	45 (84)	Evansville IN MPA	PILS Lite	8/6/2026	9/10/2026	10/8/2026	10/15/2026	11/5/2026	11/10/2026	11/12/2026
Three	46 (85)	Fresno CA P&DC	PILS Lite	8/13/2026	9/17/2026	10/15/2026	10/22/2026	11/12/2026	11/17/2026	11/19/2026
Three	47 (86)	Akron OH P&DC (PILS-1)	PILS	8/13/2026	9/17/2026	10/15/2026	10/22/2026	11/12/2026	11/17/2026	11/19/2026
Three	48 (87)	Roanoke VA P&DC	PILS Lite	8/13/2026	9/17/2026	10/15/2026	10/22/2026	11/12/2026	11/17/2026	11/19/2026
Three	49 (88)	North Houston RPDC (PILS-2)	PILS	8/20/2026	9/24/2026	10/22/2026	10/29/2026	11/19/2026	11/24/2026	11/26/2026
Three	50 (89)	West Palm Beach FL P&DC (PL 2)	PILS Lite	8/20/2026	9/24/2026	10/22/2026	10/29/2026	11/19/2026	11/24/2026	11/26/2026

New RPDC Projects

- Dallas
 - Campus Review
 - RTH: ~ +100K July 11
- Denver
 - Denver PDC → Denver RPDC
 - Denver NDC → Denver RTH (Northwest)
- Los Angeles
 - Campus Review
- Fargo
- Puerto Rico

Denver RPDC

Denver RPDC

- Outgoing and Destinating Packages
- Remove existing package equipment
- Install 5 PILS
 - 7/16
 - 7/16
 - 9/3
 - 9/10
 - 9/10

Denver- Current OSL

CURRENT MACHINE SETS		
MACH TYPE	COUNT	BIN NBR
DBCS	29	270
DBCS	1	254
DBCS	1	238
DBCS	9	222
DIOS	5	222
LCTS	4	N/A
AFSM	3	N/A
AFCS	8	N/A
LCREM	1	N/A
HTPS	1	388
HDUS	1	107
SPSS	1	196
SIPS+	2	200

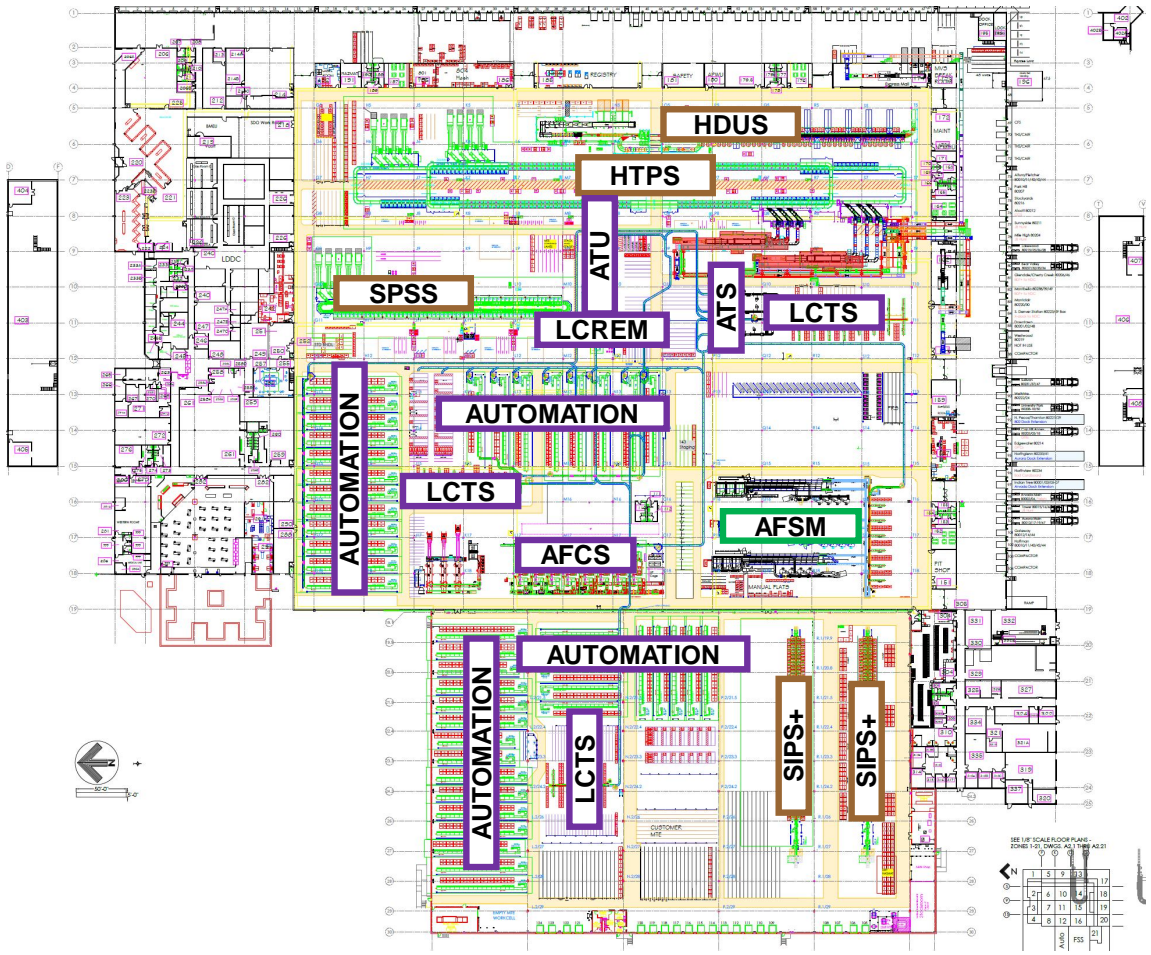

Denver- Future OSL

CURRENT MACHINE SETS		
MACH TYPE	COUNT	BIN NBR
DBCS	20	302
DBCS	11	270
DBCS	1	254
DBCS	1	238
DIOSS	4	270
HSTS	1	N/A
AFSM	3	N/A
AFCS	5	N/A
LCREM	1	N/A
PILS	5	200
HDUS	1	107

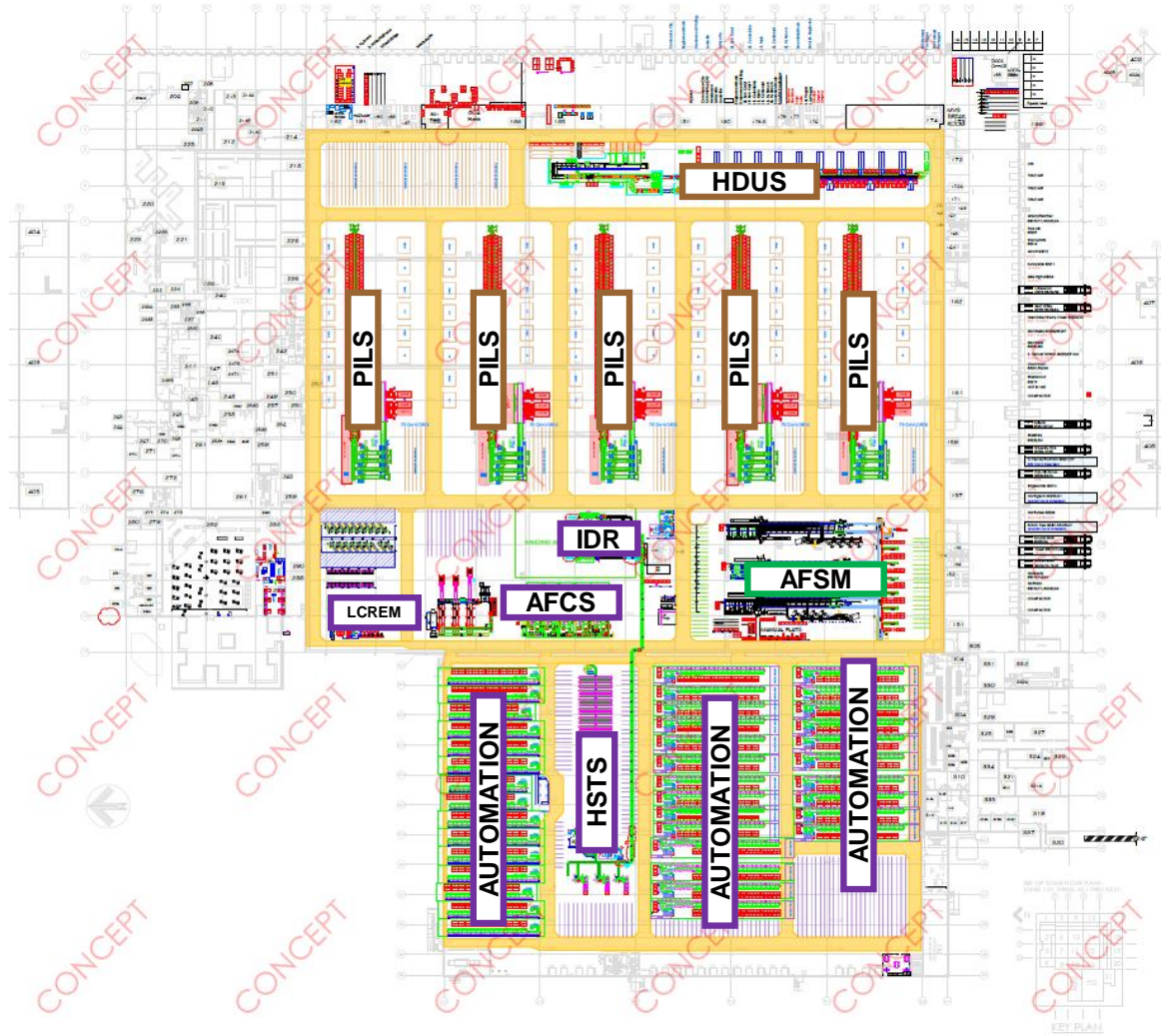

Denver RTH Insourcing

Denver RTH - Insourcing

- ❑ Insourced by 2/23
 - ❑ 3 phases: 2/09, 2/16, 2/23
- ❑ 3 Locations
 - ❑ Denver NDC:
 - ❑ 88K
 - ❑ Salt Lake City PDC
 - ❑ 61K
 - ❑ Week of 4/27 – volume shifts to Denver NDC
 - ❑ San Francisco NDC
 - ❑ 112K
- ❑ Relocated 3 SIPS+ (48 bin) from AZ

Memphis TN RPDC

Memphis TN RPDC - Notes

- Finalize volume to be ran at the RPDC in Phase 1 (Peak)
 - RTH
 - 20K: TBD
 - OG from MPA: 5/16
 - OG from Little Rock: 5/30

- Equipment Schedules
 - PILS 1: 11/21
 - PILS 2: 11/28
 - USS XL: 11/18
 - PILS 3: 4/16
 - PILS 4: 4/30
 - Matrix Sorter - TBD

Memphis TN RPDC – Phase 1 (11/03/25)

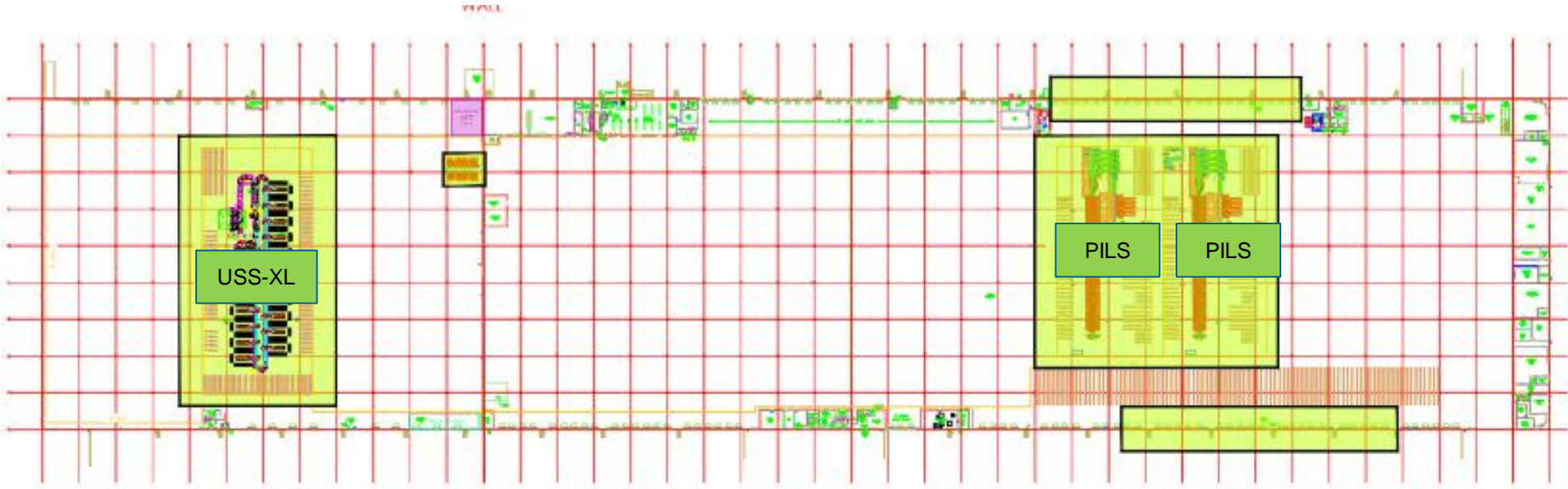

Phase Timeline
Phase 1 (11/03/2025)
Phase 2 (03/01/2026)
Phase 3 (06/30/2026)

Phase 1 Equipment Set	Target Completion Date
2 PILS (200 Bins)	
1 USS XL (18 Legs)	

Memphis TN RPDC – Phase 2 (03/01/2026)

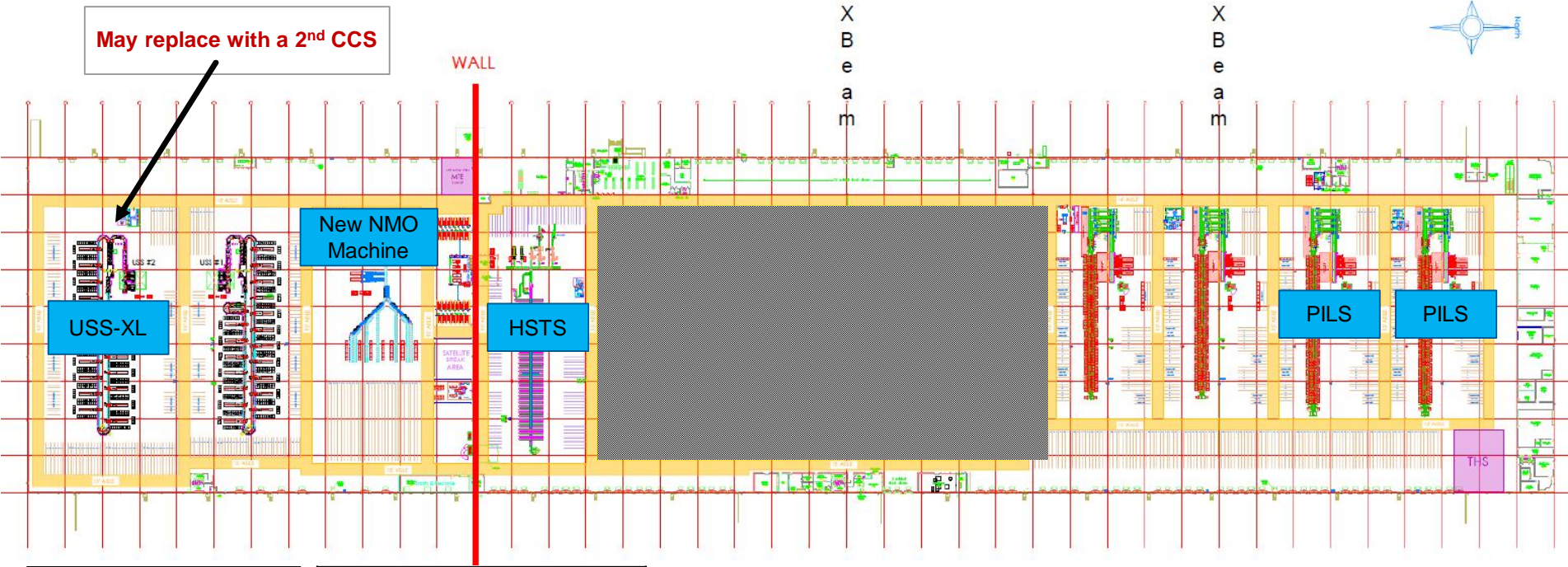

Phase Timeline
Phase 1 (11/03/2025)
Phase 2 (03/01/2026)
Phase 3 (06/30/2026)

Phase 2 Equipment Set
2 PILS (200 Bins)
1 USS XL (18 Legs)
New NMO Machine
HSTS (92 Legs)

St. Louis PSA

St. Louis PSA – Notes

- PSA Equipment Schedule
 - 2 SPSS vs SIPS+
 - CCS vs USS XL
 - HSTS: TBD
 - RTH
 - 01/12/2026:
 - 67K
- St Louis Annex
 - 12/26/2025: Closed
- St Louis NDC
 - Replace APBS with 2 SIPS+
 - Dates:
 - 2/12/26
 - 3/19/26

St Louis PSA – Phase 1 Layout

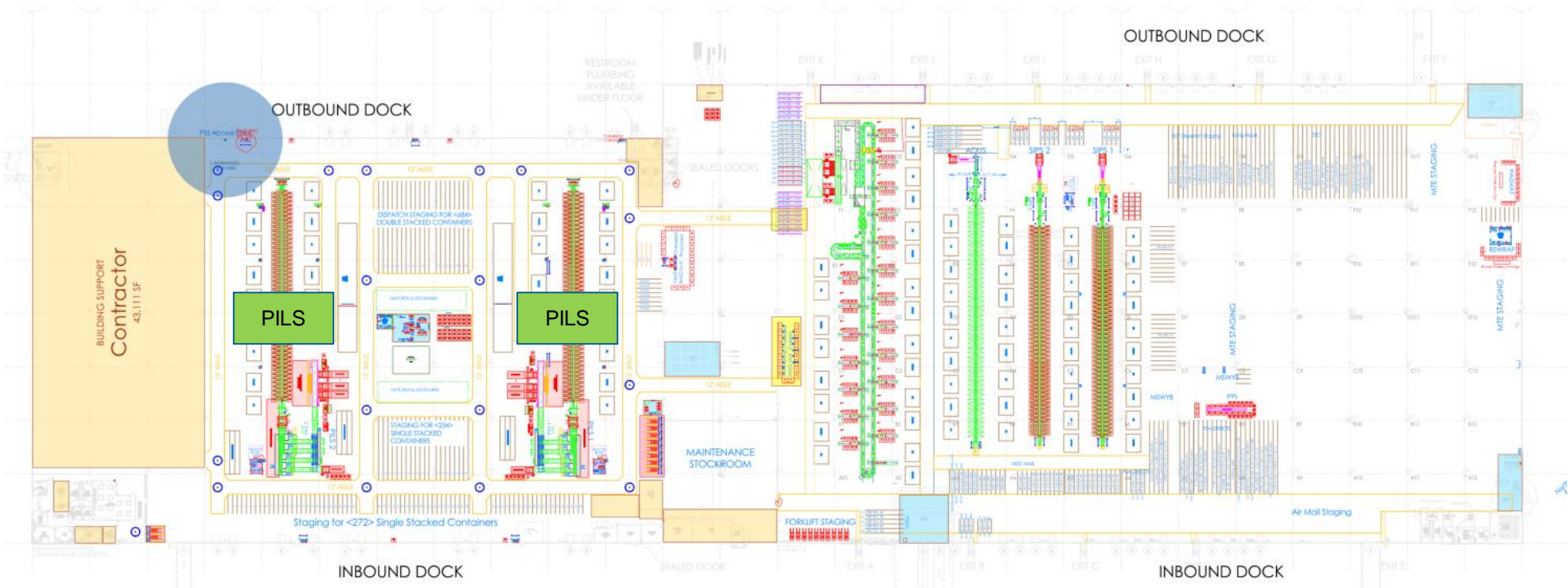

Phase Timeline	
Phase 1 (8/4/2025-10/22/2025)	
Phase 2 (2/19/2026-7/13/2026)	

Phase 1 Equipment Set	Target Completion Date
2 PILS	10/22/2025

St Louis MO RPDC Concept OSL V03e

Current Equipment Set	Proposed Equipment Set
2 PILS (200 Bins)	2 PILS (200 Bins)
2 SIPS (200 Bins)	2 SPSS MOD (100 Bins)
1 ADUS (200 Bins)	1 HSTS (68 legs)
	1 CCS

Notes:

- 10 additional dock door locations/naming in progress
- CCS layout is conceptual
- RTH Cross dock based on current operation, subject to change based on final site list/anticipated volume

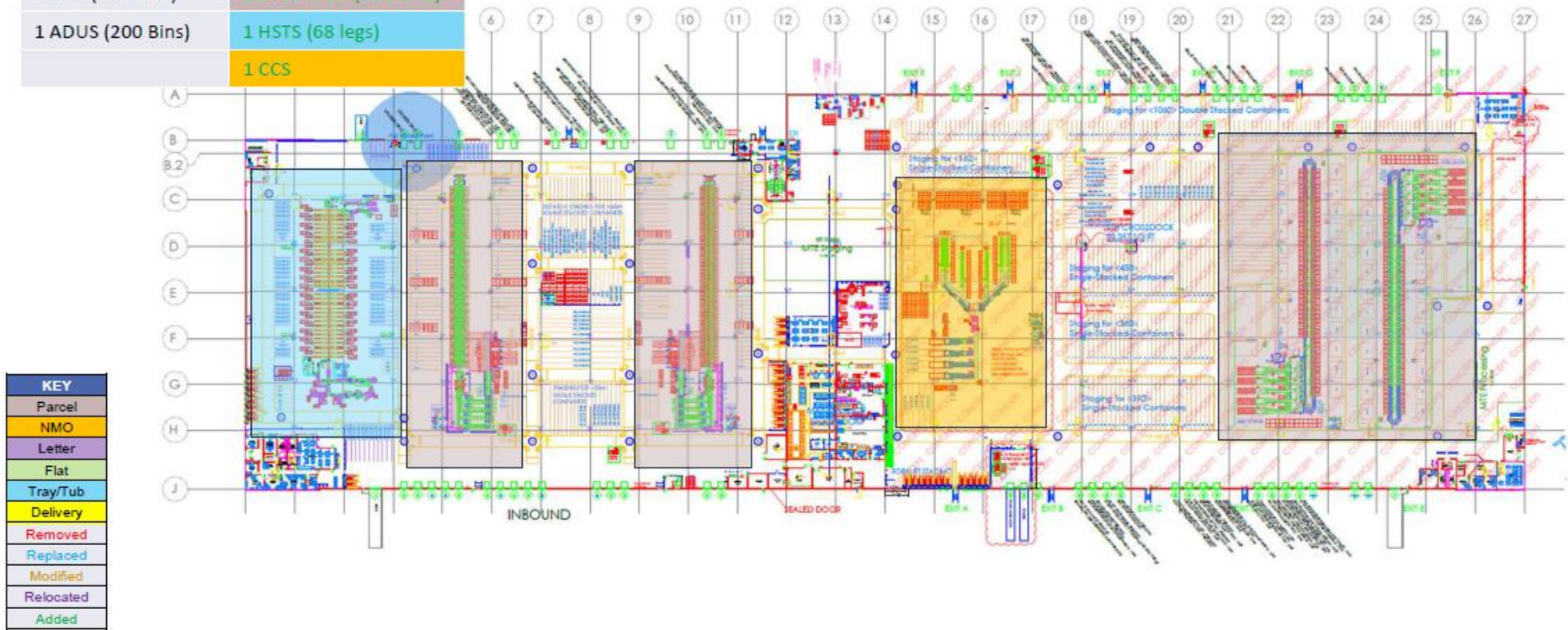

KEY
Parcel
NMO
Letter
Flat
Tray/Tub
Delivery
Removed
Replaced
Modified
Relocated
Added

St Louis PSA – Phase 2 Layout

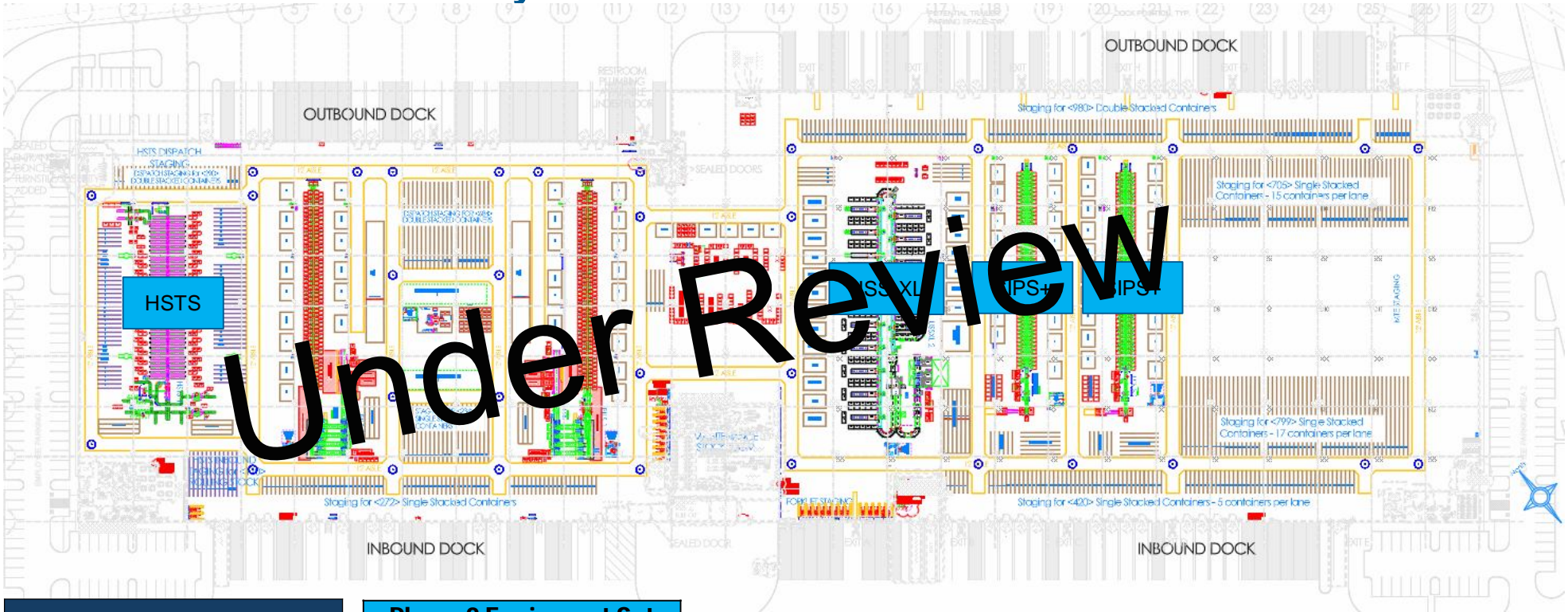

Under Review

Phase Timeline
Phase 1 (8/4/2025-10/22/2025)
Phase 2 (2/19/2026-7/13/2026)

Phase 2 Equipment Set
2 SIPS+
1 USS-XL
HSTS

Birmingham AL RPDC

Birmingham RPDC - Notes

- Equipment Schedules
 - SIPS+ relocated from PSA: 11/22
 - PILS 1: 11/28
 - PILS 2: 7/9
 - PILS 3: 7/9

Birmingham RPDC – Phase 1B



Birmingham RPDC – Final State Layout

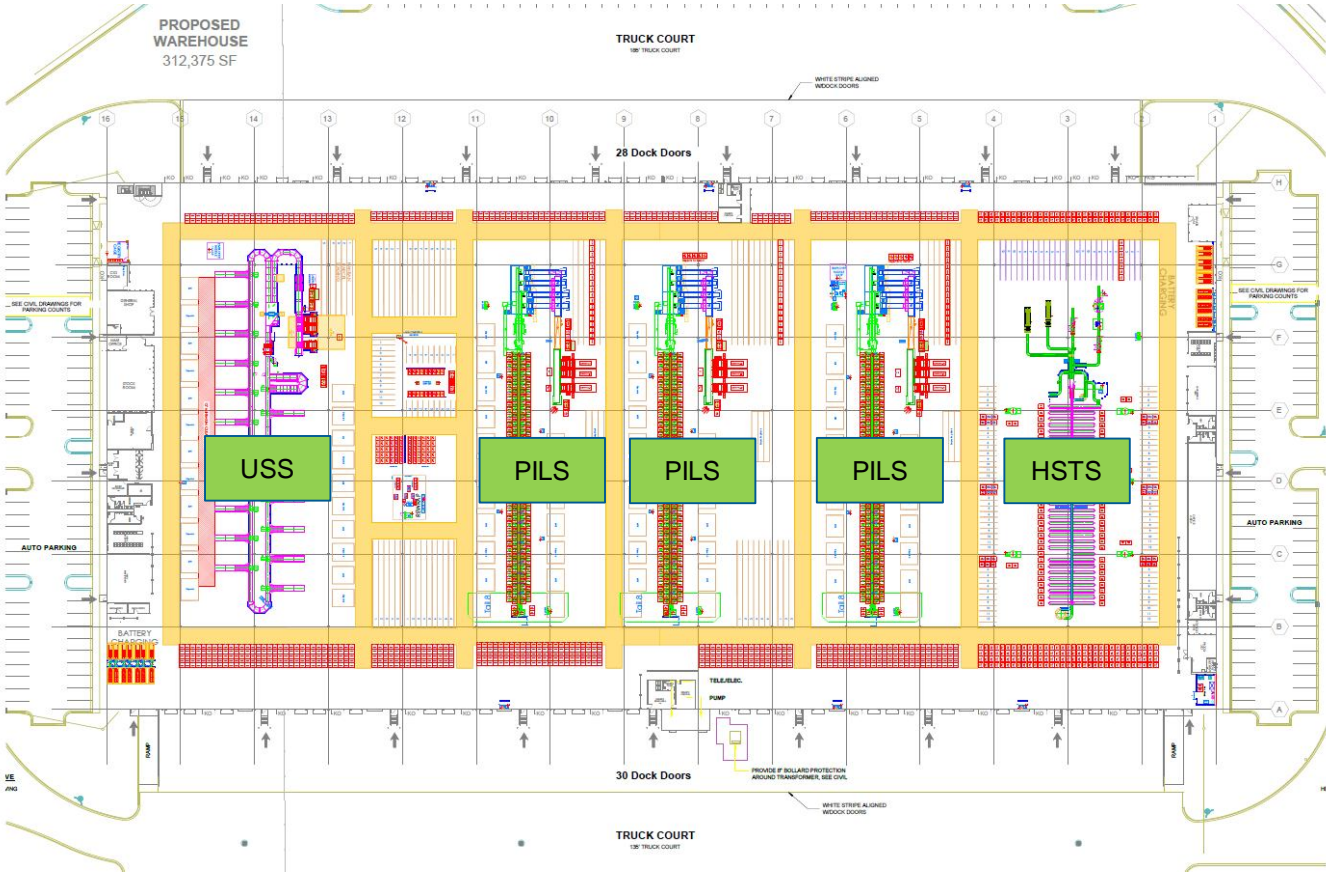

Future Equipment Set
PILS (3)
USS
HSTS

New Jersey RPDC

New Jersey RPDC - Notes

- ❑ 12/01: 6 Strands on MaRS
 - ❑ 400K capacity thru PEAK
 - ❑ 600K capacity on Sundays
 - ❑ RTH
 - ❑ 01/12/2026:
 - ❑ None planned
- ❑ 11/01: Relocate OG STC and OG NMO operations
 - ❑ Create space for D2M and child SIPS
 - ❑ New Jersey NDC Annex (old Greater Newark Facility)
 - ❑ Approx thru July 2026
- ❑ **MARS available 3/21**
- ❑ Finalize Metro Plan
- ❑ International part of Building - OSL
- ❑ **Pennwood offload: 4/6 – 6/6 – Not required**

Greensboro RPDC

Greensboro RPDC - Notes

- ❑ RTH volume
 - ❑ 01/12/2026:
 - ❑ 132K
 - ❑ X Dock containers – 2,500
 - ❑ Mitigation: CTHO and JAX PSA
 - ❑ Increase working, reduce X Dock – eliminate mitigation
 - ❑ TBD:
 - ❑ 160K (Total of 292K)
- ❑ APBS removal post PEAK
- ❑ Annex
 - ❑ CCS (2): 12/01 – 12/15
 - ❑ RTH NMOs
- ❑ THS Insourcing June 2026

Kansas City RTH

Kansas City RTH - Notes

- Continuing to hire
- Adjust workload when staffing supports
- 11/15: Relocate the STC from the St. Louis NDC to the Kansas RTH
- Increase RTH volume
 - 01/12/2026:
 - 116K
 - TBD:
 - 110K (Total of 340K)

Dallas RTH

Dallas RTH - Notes

- ☐ Increase RTH volume

- ☐ Jan 12:

- ☐ +36K – (Total of 582K)

Miscellaneous

Other Plants - Notes

- Indianapolis
 - MPA #1
 - Cross Dock Operation – indefinite
 - APPS thru PEAK ONLY

- Oak Creek – Milwaukee
 - THS Insourcing **May 2026**

- Facilities that will no longer process RTH effective Jan 12:
 - Des Moines
 - Atlanta
 - Charlotte

Jacksonville RPDC

Jacksonville RPDC - Notes

- Insourcing FL STC
 - 09/22: Phase 1
 - 09/29: Phase 2
 - 10/06: Phase 3
 - Complete
- PSA for Tallahassee offload
 - 02/26

Appendix

DFA Acronyms

- ❑ **RPDC:** Regional Processing & Distribution Center
- ❑ **LPC:** Local Processing Center
- ❑ **PSA:** Package Support Annex
- ❑ **MaRS:** Matrix Regional Sorter
- ❑ **SIPS:** Single Induction Package Sorter
- ❑ **MEWS:** Matrix East West Sorter
- ❑ **MIMS:** Multiple Induct Matrix Sorter
- ❑ **HOPS:** High Output Package Sorter
- ❑ **CHOPS:** Chained HOPS
- ❑ **D2M:** Dock To Machine
- ❑ **PILS:** Parallel Induction Linear Sorter
- ❑ **USS XL:** Universal Sort System handles larger packages
- ❑ **FRS:** Flex Rover Sorter
- ❑ **RTO:** Regional Transportation Optimization
- ❑ **CCS:** Cascading Conveyor System (NMOs)
- ❑ **ePSM:** Enhanced Package Sorting Machine
- ❑ **LCUS:** Low-Cost Universal Sorter: NMOs, trays, tubs
- ❑ **LCTS:** Low-Cost Tray Sorter
- ❑ **HSTS:** High Speed Tray Sorter
- ❑ **RTH:** Regional Transfer Hub (Go East / Go West)
- ❑ **OTH:** Origin Transfer Hub
- ❑ **OPF:** Origin Processing Facility
- ❑ **NDLL:** National Distribution Labeling List
- ❑ **ADC:** Area Distribution Center
- ❑ **AADC:** Automated Area Distribution Center
- ❑ **OMX:** Origin Mixed ADC
- ❑ **MXD:** Mixed ADC
- ❑ **DNDC:** Destination Network Distribution Center
- ❑ **DSCF:** Destination Sectional Center Facility
- ❑ **CUS:** Compact Universal Sorter
- ❑ **VRS:** Video Relabeling System

Chicago RPDC

Chicago RPDC - Notes

- ❑ APPS being upgraded
 - ❑ 11/01: 100% operational
- ❑ Power Upgrade: 11/01

- ❑ South Suburban
 - ❑ 9/15: 5 DIOSS/DBCS removals
 - ❑ 10/01: FRS being installed

Phoenix RTH

Phoenix RTH - Notes

- MEWS operational
- Increase RTH volume
 - Jan 12:
 - +133K (Total of 505K)

Charlotte RPDC

Charlotte RPDC - Notes

- ❑ Johnson City
 - ❑ 09/06: Operational